



TEAL Initium

DC Fast Charging Station



TEAL Initium Features

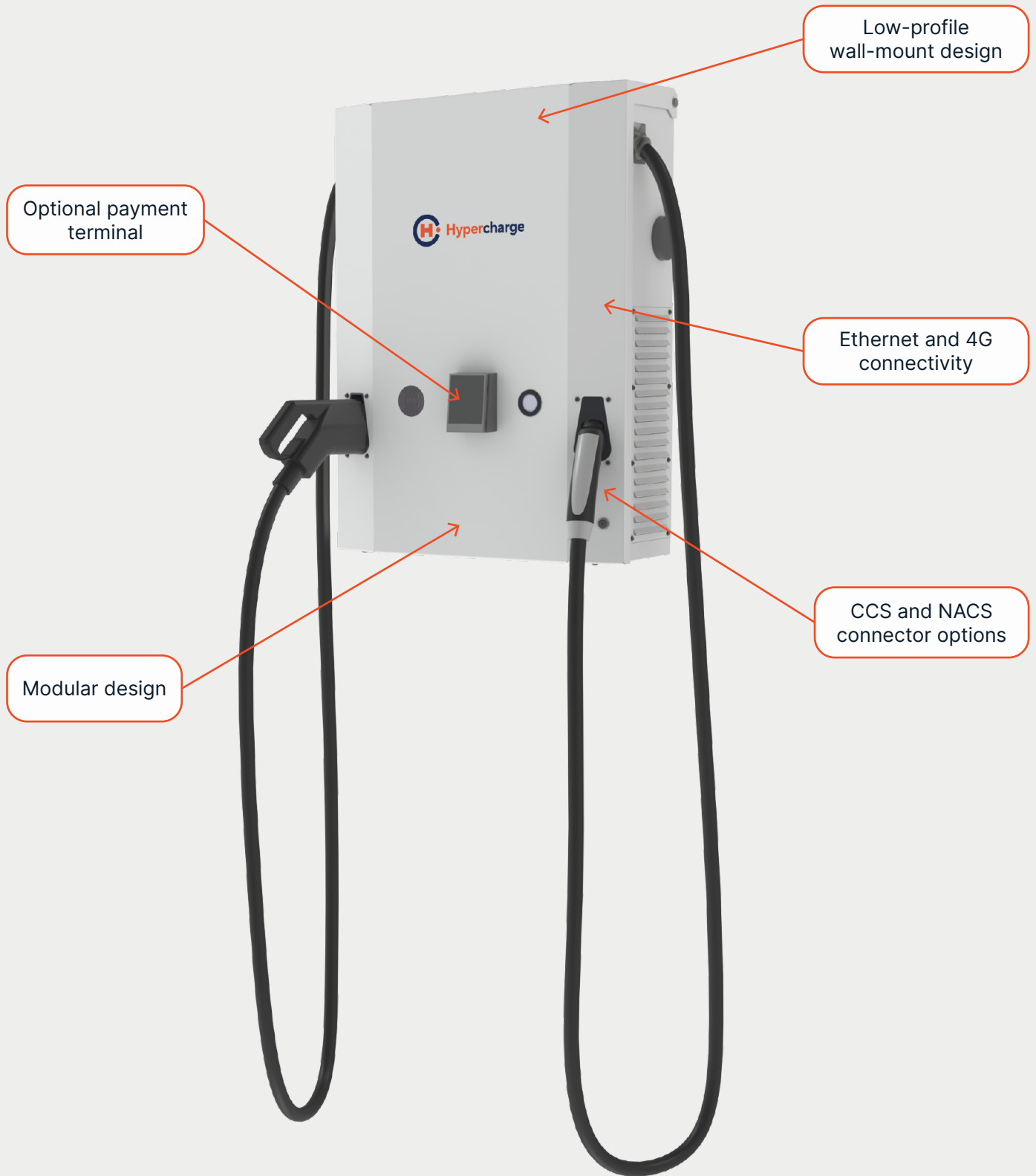



TEAL Initium

Specifications (30-40 kW)

GENERAL SPECIFICATIONS	
OUTPUT CURRENT	100A-30kW, 133A-60kW
OUTPUT POWER	80/60KW, 150-1000V dc
3Φ AC INPUT (3P+PE)	380V TO 480V
FREQUENCY	50HZ/60HZ
POWER FACTOR	>0.99
EFFICIENCY (MAX)	> 97.3% @ FULL LOAD
OCPP VERSION	1.6J AND 2.0.1

AC INPUT
Voltage Range: 340V-528V 3Φ (3P+PE)
Rated Voltages: 480V/440V/415V/400V/380V 3Φ (3P+PE)
Max Continuous Input Current At: 480V Volts: 30kW: 38A, 40kW: 51A
Frequency 50Hz/60Hz
Power Factor Greater Than 0.99
Max Full Load Efficiency > 97.5%

DC OUTPUT
Output Voltage Range CCS: 150-1000Vdc NACS: 150-1000Vdc
Continuous Output Current: 100A-30kW, 133A-40kW
Connector Options (Based on Customer Specs): 2 CCS/2 NACS/1 CCS + 1 NACS
Voltage Accuracy ±0.5%
Current Accuracy ±1%

PROTECTION
Input Protection: SPD, OCP, OVP, OTP, OPP
Output Protection: IMD, OCP, OVP, OTP, LVP, SCP

USER INTERFACE AND CONTROL
PCI Compliant Payment Terminal Optional (Tap/Insert/Swipe/NFC)
User Authentication RFID: Supports ISO 14443A/B
OCPP 1.6J and 2.0.1

COMMUNICATION
External: Ethernet and 4G
Internal: CAN bus/Ethernet/RS485/RS232

ENVIRONMENTAL
Rated Temperature Range -50°C to +50°C (-58F to 122F), Power Derating Starts at +52 °C/126F Operating Temperature Range -60°C to +70°C (-76F to 158F)
Humidity 5%-95% RH, Non-Condensing
Altitude ≤ 2000m
Aluminum Type 3R Rainproof Enclosure
Air-Cooled System

REGULATION
Compliance UL 2202, UL 2231-1, UL2231-2, UL50E, CSA C22.2 No 346:22, cCSAus (pending)
Charging Interface ISO15118 (CCS1/NACS)



TEAL Initium

Specifications (60-80 kW)

GENERAL SPECIFICATIONS	
OUTPUT CURRENT	250A-80kW, 200A-60kW
OUTPUT POWER	80/60KW, 150-1000V dc
MAX CONNECTIONS	2 SIMULTANEOUS VEHICLES
3Φ AC INPUT (3P+PE)	380V TO 480V
FREQUENCY	50HZ/60HZ
POWER FACTOR	>0.99
EFFICIENCY (MAX)	> 97.5% @ FULL LOAD
OCPP VERSION	1.6J AND 2.0.1

AC INPUT
Voltage Range: 340V-528V 3Φ (3P+PE)
Rated Voltages: 380V/400V/415V/440V/480V 3Φ (3P+PE)
Max Continuous Input Current At 480V Volts: 60kW: 76A, 80kW: 102A
Frequency 50Hz/60Hz
Power Factor Greater Than 0.99
Max Full Load Efficiency > 97.5%

DC OUTPUT
Output Voltage Range CCS: 150-1000Vdc NACS: 150-1000Vdc
Continuous Output Current: 266A-80kW, 200A/60kW
Connector Options (Based on Customer Specs): 2 CCS/2 NACS/1 CCS + 1 NACS
Voltage Accuracy ±0.5%
Current Accuracy ±1%

DC METERING
Optional Class C 0.5 Calibrated Meters Exceeding Requirements of CTEP, NTEP and MC
cCSAus Marked
COMPLIANCE: CAN/CSAC22.2 No. 61010-1-12, UPD1:2015, UPD2:2016, AMD1:2018, COR1:2019, UPD3:2023 UL 61010-1 3rd ed (Rev. Jun 6, 2023) CSAC22.2 No. 61010-2-030:18 UL 61010-2-030, 2nd Edition, RevDec 21, 2018

USER INTERFACE AND CONTROL
PCI Compliant Payment Terminal Optional (Tap/Insert/Swipe/NFC)
User Authentication RFID: Supports ISO 14443A/B
OCPP 1.6J and 2.0.1

COMMUNICATION
External: Ethernet and 4G
Internal: CAN bus/Ethernet/RS485/RS232

ENVIRONMENTAL
Rated Temperature Range -50°C to +50°C (-58F to 122F), Power Derating Starts at +52 °C/126F Operating Temperature Range -60°C to +70°C (-76F to 158F)
Humidity 5%-95% RH, Non-Condensing
Altitude ≤ 2000m
Aluminum Type 3R Rainproof Enclosure
Air-Cooled System

PROTECTION
Input Protection: SPD, OCP, OVP, OTP, OPP
Output Protection: IMD, OCP, OVP, OTP, LVP, SCP

REGULATION
Compliance UL 2202, UL 2231-1, UL2231-2, UL50E, CSA C22.2 No 346:22, cCSAus (pending)
Charging Interface ISO15118 (CCS1/NACS)



hypercharge.com