



XCHARGE GridLink

DC Fast Charging Station



XCHARGE GridLink Features

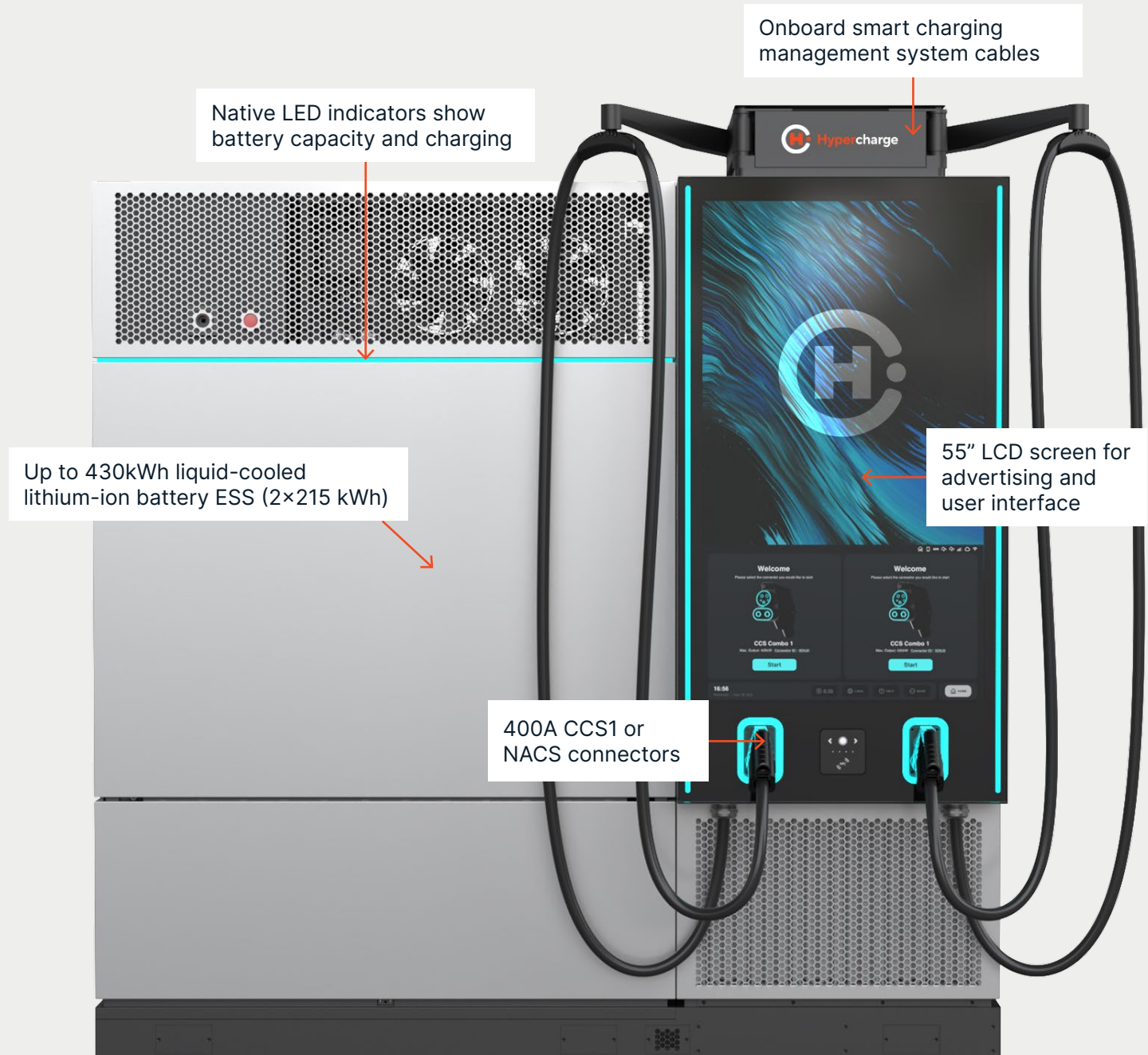



XCHARGE GridLink

Adaptive Power Capability Overview

XCHARGE GridLink includes an adjustable power output function, allowing it to adapt to a site's power availability without requiring any hardware changes.

This flexibility supports safe and reliable operation even in lower power environments and can be reconfigured as a site's power capacity evolves over time.

The power output can be adjusted via the backend or a firmware tool during commissioning or servicing:

Input Power (kVA)	ACDC Output Power (kW)	Input Current @ 208V (A)	Breaker Size @ 208V (A)	Input Current @ 480V (A)	Breaker Size @ 480V (A)	Battery Augmentation (kW)	Maximum Charging Capacity (kW)
18	10	105 A	125 A	48 A	60 A	180 kW	190 kW
28	20	134 A	150 A	61 A	80 A	180 kW	200 kW
39	30	164 A	200 A	73 A	100 A	180 kW	210 kW
60	50	223 A	250 A	99 A	125 A	180 kW	230 kW
87	75	\	\	131 A	175 A	180 kW	255 kW
113	100	\	\	163 A	225 A	180 kW	280 kW
135	120	\	\	188 A	250 A	180 kW	300 kW



XCHARGE GridLink

Specifications (1/3)

Product Specification	Type	DC charging station
	Dimension (w*d*h)	GridLink 7.34 * 3.24 * 7.72 ft
	Cable management and metal base is included	GridLink XL 12.05 x 3.24 x 7.72 ft
	Installation	Floor type
	Material	Industrial Grade Alloy
	Color	Silver
	Weight	7,936 lbs
Energy-storage-system	Cell Type	LFP L280K
	Rated Energy	215kWh/2*215kWh
	Usable Energy (SAT)	205 kWh/2*205kWh
	Max. recharge Power	60kW/120kW
	Battery charging Rate	≤0.6C
	Battery discharge Rate	≤1C
	Battery Efficiency	≥94.5% under nominal situation
Charging system	Connectors	2
	Charging power	DC Max. 300 kW
	Power distribution	2 connectors intelligent distribution
	Charging voltage	300V~1000V
	Efficiency	≥96.5%
Meter	AC side	AC meter
	DC side	2-access DC meter
Cooling system	Battery cooling	Liquid-cooled
	Power modules	Liquid-cooled
	Cable cooling	Air-cooled



XCHARGE GridLink

Specifications (2/3)

Fire suppression system	Water
Payment System	RFID, credit card
Connectivity	GSM & LTE & LAN
Communication	OCPP 1.6J & OCPP 2.0.1
Applicable site	Outdoors
Ambient temperature	-13°F to 131°F
Humidity	≤95%, No condensation
Altitude	≤6562 ft
EMC Emission	Class A
Medium	No explosive hazard, No toxic & harmful gases.
Interference	No strong vibration and shock, no strong electromagnetic interference
AC side Voltage	3Phase 208V _{AC} or 480V _{AC} +/- 10%
Input Frequency (AC)	60Hz
DC Voltage Range	200VDC-1000VDC
DC Constant-power voltage range	300VDC-1000VDC
Nominal power output (Rectifying Mode)	300 kW
Nominal power output (Off-Grid Mode)	180 kW
Nominal power output (TO-Grid Mode)	120 kW (including Auxiliary power consumption)



XCHARGE GridLink

Specifications (3/3)

DC Current output	Max. 400A CCS1 or NACS continuously
Photovoltaics	Input voltage range: 300-825 VDC Max Power input: 60 kW
Off-grid Function	Able to charge EV during blackouts. Able to provide energy to an AC load during blackouts
IP ranking	IP54
Safety protection	Input protection, Overcurrent protection, Lightning protection, Over-temperature protection, output over-voltage protection, fan protection, short circuit protection, Emergency button, Flood protection, Ground protection, Dumping protection, Smoke protection, on-board fire suppression
Battery	UL1642(cell), UL1973A, UL 9540A
System	UL9540, UL2202, UL2231-1, UL1973, FCC part15B and ICES-003
B2G	UL 1741
Photovoltaic UL 1998, UL991, UL1699B	

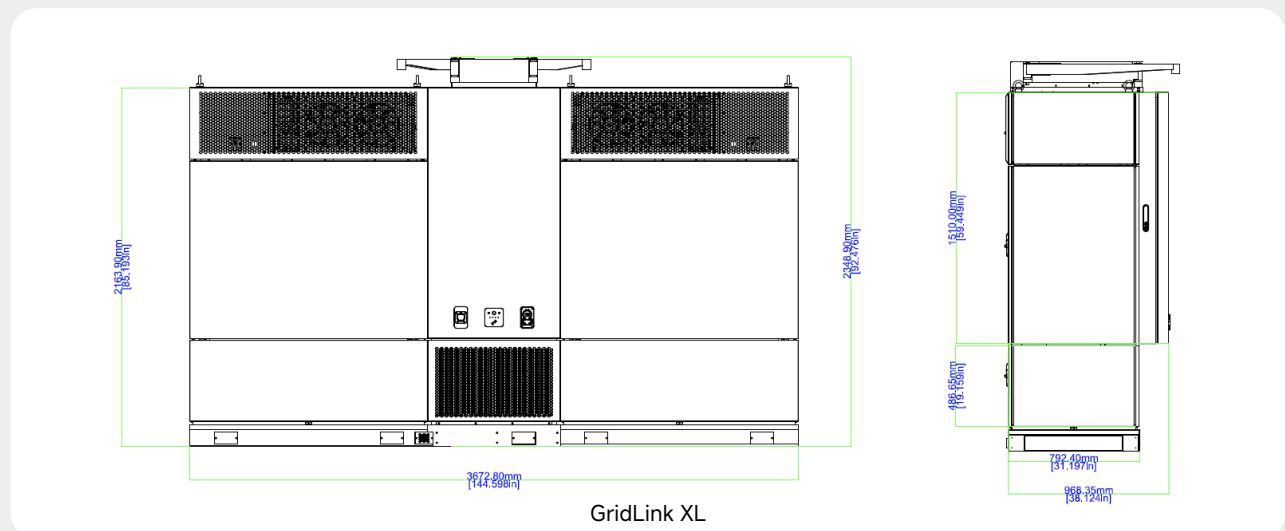



hypercharge.com